



Protecting Your Adventure Lifestyle

Warrior Products, Inc.
11100 SW Industrial Way
Tualatin, OR 97062

Phone (888) 220-6861
Fax (503) 692-0364
customerservice@warriorproducts.com

941 – 4dr JK FULLARMOR INSTALLATION SHEET

***PLEASE NOTE:** If you have purchased a portion of this kit and not the entire kit, the Contents below will vary.

Kit Contents:

Item	Qty	Item	Qty
Front Fender Armor (L&R)	1 pair	Rear Tub Side Armor (L&R)	1 pair
Front Door Armor (L&R)	1 pair	Logo Badge Armor	1 pair
Rear Door Armor (L&R)	1 pair	#12 x 1/2" Stainless Square drive Self-Tapping Screws	100
		#3 Square Drive Bit	1

Required Items:

- Drill
- 5/32" Drill Bit
- Masking Tape
- 1/4" Bit Driver (for Square Drive Bit)
- Marker
- Hammer
- Center Punch
- Clear RTV Silicone (optional)

Installation:

1. To correctly position the Armor panels, begin by marking a 1/2" border around the doors to use as a positioning guide. Place some masking tape along the edges to mark on with a pen. Next, place a number of marks 1/2" from the edge along the front, bottom, and rear of the doors. (**Fig. 1**) Also make 1/2" marks for the front fender at the edge near the front door, and for the Rear Tub Side Armor at the edge near the rear door.



Figure 1

2. Using the 1/2" marks as a guide, carefully position each Armor Panel to maintain an even border around each piece. The Rear Tub Side Armor, and the Front Fender Armor will align at the top with the ridge of the Jeep's sheet metal body. Also make sure to position the door panels so that they are evenly centered between the hinges. Please note that the 1/2" marks may not perfectly align with the edges of the panel, they are only to be used as a guide to maintain an even border. An extra set of hands, and some clamps will be extremely helpful to keep the panels in place while marking. Once satisfied with the placement of the panel, carefully mark each hole with a permanent marker (making sure not to move the panel). Repeat this process until all panel holes have been marked. The triangular center badge piece is optional and you can leave it off if you prefer. (**Fig. 2**)

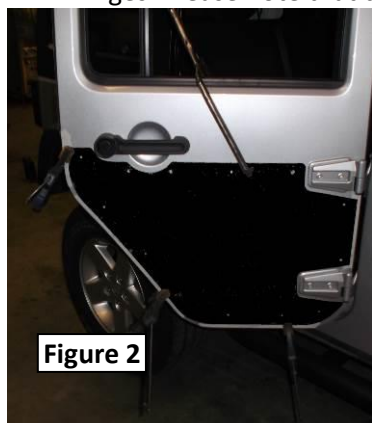

Figure 2



• INNOVATION •

• SERVICE •



Protecting Your Adventure Lifestyle

Warrior Products, Inc.
11100 SW Industrial Way
Tualatin, OR 97062

Phone (888) 220-6861
Fax (503) 692-0364
customerservice@warriorproducts.com

3. After all the hole locations have been marked, prepare them for drilling by carefully center punching the center of each mark. The center punch will keep the drill bit from wandering while drilling the holes. **(Fig. 3)**
4. Next, use a drill with a 5/32" bit to drill all of the holes that you just center punched. Be careful not to drill deeper than the first layer of sheet metal. You can wrap some tape around the drill bit as shown below (just leaving the tip exposed) to act as a depth stop and prevent drilling too deep. **(Fig. 4)** After the holes have been drilled, hold the panel up to verify alignment of all the holes.



Figure 3

5. Once the holes are drilled, you can remove the masking tape and start attaching the Armor Panels.

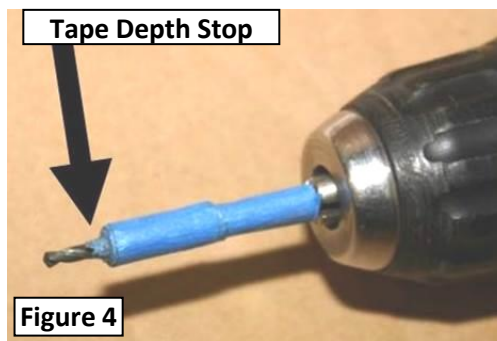

Figure 4



Optionally, you should

use RTV silicone (clear works best) to help seal the panels and/or protect the drilled holes. The RTV silicone can be applied as a thin bead along the perimeter of the Armor Panel on the side that will be in contact with the Jeep, or you may choose to place a small amount at each hole before starting the screw.

6. When you are ready, place an Armor Panel in its correct position and loosely start two of the Stainless Steel, Square Drive screws using the #3 Square Drive Bit to hold the panel in place. The sheet metal of the Jeep JK is very thin, therefore, we recommend that you tighten the screws by hand to avoid stripping. **(Fig. 5)** If you choose to use a power driver, we suggest you use one with a clutch set to a light setting and tighten them until they are "almost snug" then finish with the hand driver to snug them up. **DO NOT OVERTIGHTEN!!!**

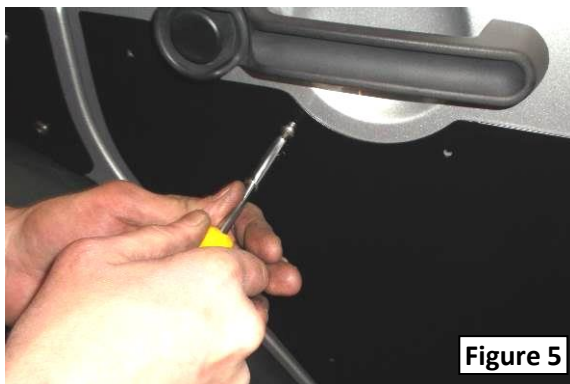

Figure 5



7. Repeat this process for the remaining Armor Panels to complete installation.

If you need further assistance installing your product, please contact us by email at customerservice@warriorproducts.com or call us at (888) 220-6861.

THANK YOU FOR PURCHASING WARRIOR PRODUCTS

QUALITY • INTEGRITY • INNOVATION • SERVICE