



Warrior, Inc.
 11100 SW Industrial Way
 Tualatin, OR 97062
 Phone: (888) 220-6861
 Fax: (503) 692-0364
customerservice@warriorproducts.com
www.warriorproducts.com

QuickLatch Axe/Shovel Mount (#10375) / QuickLatch Off-Road Jack Mount (#10370)

Kit Contents:

<u>Item</u>	<u>Qty</u>	<u>Item</u>	<u>Qty</u>
QuickLatch Accessory Mount	2	5/16" x 3" Button Head Screw Stainless	4
Square Clamp	2	5/16" Hex Nut	4
Backing Plate	2	5/16" SAE Washer	8
Standoff Box	2	5/16" Split-Ring Lock Washer	4

NOTE: A 3/16" Hex (or Allen) 'L-Key' and a 1/2" wrench is required for installation (see image).



Installation:

Installation should be fairly straightforward after you determine your desired configuration and placement. The QuickLatch mounts may be installed multiple ways on your Warrior Products Platform Roof Rack, Bed Rack, or MOD Rack side rails. This kit will also attach to the square crossbars of other Warrior Products racks and hitch baskets. This product may be installed universally on flat surfaces by drilling appropriate mounting holes (if necessary). With some creativity, hardware, and some metal plates that can be easily cut to size and drilled (such as Aluminum), you can also attach these mounts to aftermarket roof racks with different cross-bar dimensions and spreads.. This can be achieved by "sandwiching" two bars between two plates, or using a plate and U-bolts placed at the correct spread and attaching the mount to the plate.

Please note that the 5/16" x 3" Stainless Steel Button Head Screws included in the kit will be longer than desired for many applications (make sure that the hardware will not contact your roof when installed). Before beginning the final installation, determine the hardware length desired for your application. You may cut the Stainless Steel Screw to length using a hacksaw, cutoff wheel, or equivalent. When cutting hardware to length, we suggest first threading a nut on the screw beyond the cut length so that you can re-shape the threads upon removal of the nut. Also make sure to sand or file any sharp edges after cutting and before removing the nut. Alternatively, you may choose to purchase new hardware of a desired length from a hardware store.

The components of the kit are shown in the image on the next page along with a brief description of the function of each part. Due to the variety of mounting options provided with this kit, you will likely have leftover components after your installation is complete. We suggest that you keep any unused components so that you may use them in the future if you choose to re-configure or relocate your mount.



Warrior, Inc.
 11100 SW Industrial Way
 Tualatin, OR 97062
 Phone: (888) 220-6861
 Fax: (503) 692-0364
customerservice@warriorproducts.com
www.warriorproducts.com

COMPONENTS

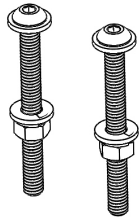

5/16" Mounting Hardware

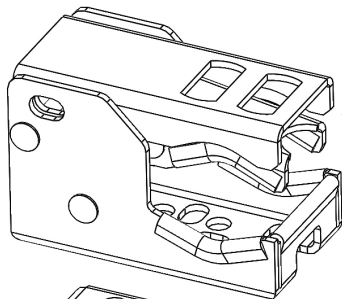

Mount

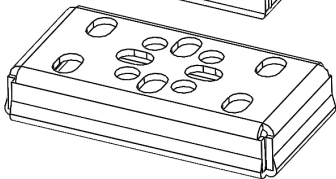

Standoff Box

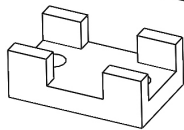

Square Clamp

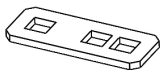

Backing Plate

Security Tab

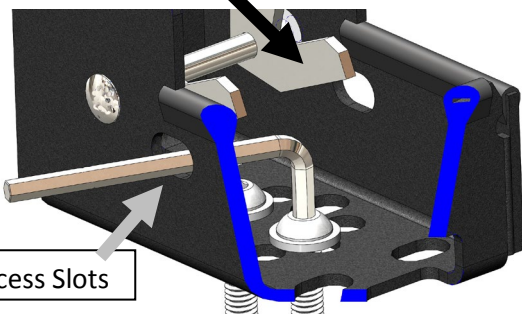

Access Slots

APPLICATION NOTES

- Hardware may be used for all applications.
- Hardware may be placed in a variety of holes in the mount depending on application.
- Button Head Screws may be cut to length.
- **Make sure that the screw cannot contact roof surface.**
- Purchase desired length hardware if preferred.
- Axe / Shovel / Paddle version, or Off-road jack version.
- Adjustable for a range of grip sizes and grip strength.
- **It is possible to crush lightweight handles found on some Paddles, Oars, and tools if overtightened! Use Caution!**
- Lockable.
- Adjustment and operation details at the end of these instructions.
- Adds height to the Mount to gain additional clearance for accessories.
- MUST be used when mounting on a MOD rack side rail to provide clearance for the Square Clamp.
- When mounting the Off-Road jack version on a flat surface the Standoff Box provide clearance for jack mechanism.
- Should be used when positioning the Mount in a mounting bucket of a "WP" Platform rack.
- Use when mounting on a Warrior Products rack Square Crossbar.
- Use when mounting on a Warrior Products MOD rack rail to engage the cutouts.
- Always use the Backing Plate to reinforce the Square Clamp.
- The Backing Plate is used to reinforce the Plastic Square Clamp.
- The hardware will pass through the two outermost holes (the center hole will not be used).
- The Backing Plate should be placed next to the Square Clamp and then followed by the 5/16" SAE washers.

The Off Road Jack version of the QuickLatch has a slightly taller body to provide additional clearance for the Jack mechanism. The taller sides of the mount make it difficult to access the button head screws for installation. There are access slots in the side of the body so that you can insert the Allen "L-Key" for installation. Please note that the lever of the mount must be raised to open the access slot. The slot is blocked while closed to provide security. The cutaway section view to the left illustrates how to use the access slots.



Warrior, Inc.
11100 SW Industrial Way
Tualatin, OR 97062
Phone: (888) 220-6861
Fax: (503) 692-0364
customerservice@warriorproducts.com
www.warriorproducts.com

The QuickLatch mounts can be installed in many configurations and can be used to secure a variety of tools. Because of the range of applications, general installation information is given and can be used as a guide to help determine your installation plan. It is however at the discretion of the installer to choose the optimal configuration. Some additional components are included to aid in installation on Warrior Products Racks and MOD rail systems and some additional notes for these specific applications are given below. You may also contact Warrior Products customer service with any questions.

General Installation Information:

1. Plan to secure each QuickLatch mount with at least two (2) 5/16" or larger bolts or machine screws. Use washers and lock washers or equivalent (all holes and slots are sized so that you may use up to 3/8" hardware). Try to use holes that are symmetrically placed away from the center of the mount. The ideal placement of mounting hardware is as far spaced as possible in opposite slots of the "Middle plus Mounting Slots" (shown below). Please note that other holes are provided for versatility, but most Warrior Product specific applications will use the Middle plus Mounting Slots.
 - a. The rear mounting slots are difficult to access because of the latch mechanism. One way to use a fastener in the rear slots is to work a 3/8" Carriage Bolt in from the back opening, and carefully thread it into the slot from the inside. The slot is sized so that it will hold the 3/8" Carriage Bolt while tightening.

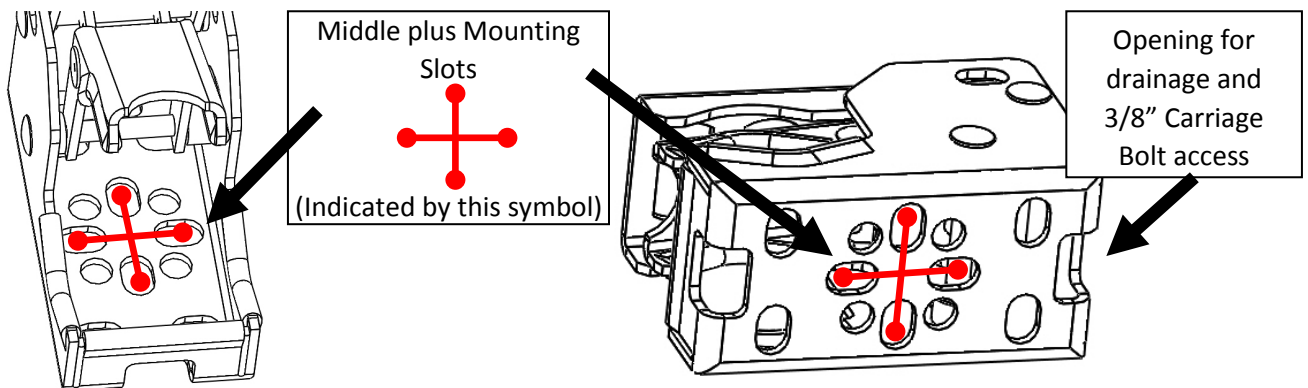

2. Align the mounts so that they are on the same level and in line with each other. They must be in line with each other (i.e. parallel to each other and spaced correctly) so that when they are being used, the handle or jack being clamped can be clamped evenly and securely by both mounts. Check that the tool that you desire to carry will fully seat into the mounts at your desired location. Add the Standoff Boxes if you need additional clearance height. For Off-Road jacks, remember that one side of the jack mechanism is larger than the other...the orientation in which you plan to mount your jack will affect the height requirement.
3. For Universal applications confirm that you are happy with the position of the mounts and carefully mark where to drill your holes if applicable.
4. After holes are drilled, loosely start all mounting hardware by bolting through the mount (and Standoff Box if applicable), re-align the mounts, and tighten hardware evenly.
5. Periodically re-check mounting hardware to make sure it is still secure.
6. Proceed to the end of this instruction for details on operating and adjusting the QuickLatch mounts.



Warrior, Inc.
 11100 SW Industrial Way
 Tualatin, OR 97062
 Phone: (888) 220-6861
 Fax: (503) 692-0364
customerservice@warriorproducts.com
www.warriorproducts.com

Warrior Products MOD rail:

The mounts are compatible with both MOD rail types. The side rails with large openings, and rear rails with smaller openings. The Standoff Box and Square Clamp must be used and oriented correctly. When positioned on a large opening rail, both the Square Clamp and Standoff Box should be vertical (with the longest sides going up and down). Position the Square Clamp with Backing Plate to fit over a set of teeth in the rail. The Button Head screws will be oriented vertically in this configuration.

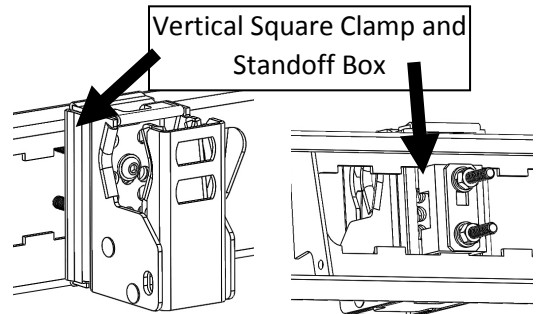

Side MOD Rail Mount (Large Cutout)

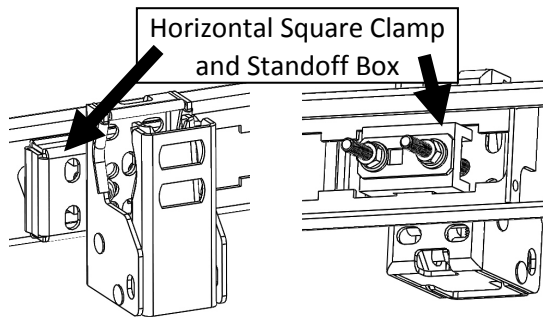

Rear MOD Rail Mount (Small Cutout)

The small MOD rail opening requires that Square Clamp and Standoff Box be installed horizontally (longest sides going side-to-side) to correctly interface with the teeth in the rail cutouts. Similarly, position the Square Clamp with Backing Plate over a set of teeth in the rail cutout, and the Button Head screws will be oriented horizontally. Please note that installing accessories on the rear rail of the Jeep MOD rack may cause interference with hardtop removal.

Warrior Platform Rack (and all Warrior Racks with 1" square crossbars):

The plastic Square Clamps with Backing Plate are used for installation on the square cross-bars of your Warrior Rack. Slide the Square Clamp over the cross-bar as shown in the image to the right and use the Backing Plate to reinforce the Clamp. When tightening the hardware, alternate between fasteners to tighten evenly. Do not distort the Square Clamp by overtightening.

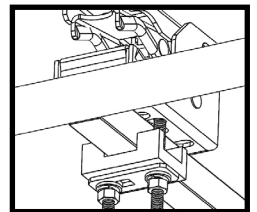

The QuickLatches can be installed in either direction, i.e. in-line with the cross-bar or perpendicular the cross-bar. For additional clearance height, install both mounts with both Standoff Boxes on top of the square cross-bars and secure with the Square Clamps and Backing Plates.

If you choose to mount one QuickLatch in a Platform Mounting Bucket and the other on a square cross-bar, use one stand-off inside the Platform Mounting Bucket and mounting the other QuickLatch directly on top of the square bar (without a Standoff Box).

When placing the Standoff Box in the bucket remove the short strips of rubber edge trim to provide enough clearance for the standoff box to fit into the Platform Mounting Bucket.

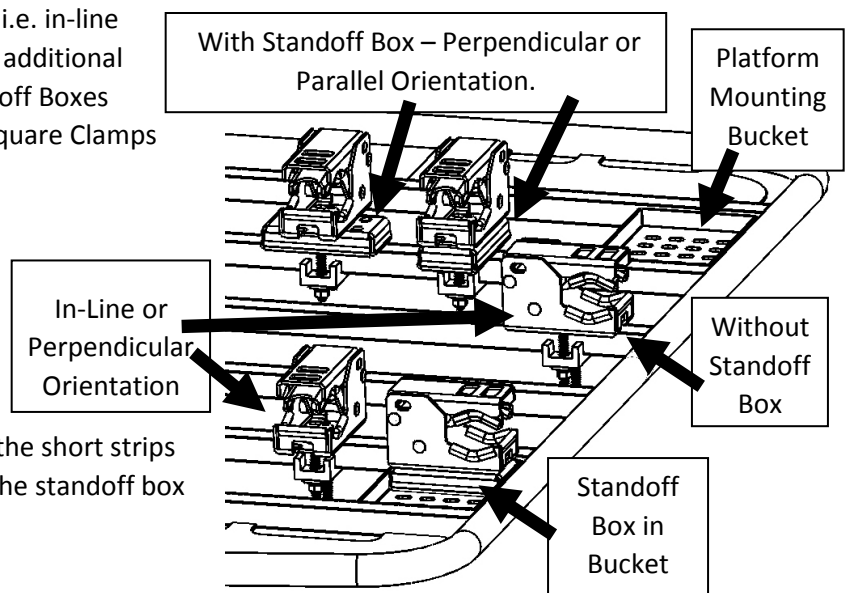



Warrior, Inc.
11100 SW Industrial Way
Tualatin, OR 97062
Phone: (888) 220-6861
Fax: (503) 692-0364
customerservice@warriorproducts.com
www.warriorproducts.com

QuickLatch Operation Instructions:

Use caution when operating the QuickLatch to avoid pinching or injury. Always close the lever with the palm of your hand, and open the lever carefully and smoothly. If the lever is too hard to close do not force it. Instead, loosen the adjustment cap screw until the lever closes firmly, but safely. If the lever is difficult to open, you can pry the lever open with a screwdriver, or pry bar...place the screwdriver through the opening of the lever closest to the edge and push down on the opposite end as shown in the lower left image.

1. Open both QuickLatches so that you can insert the Axe, Shovel, Off-road Jack, or other (hereafter referred to simply as "tool").
2. Position the tool as desired and slowly close the lever to clamp the tool. If the lever is too loose and does not firmly clamp the tool, open the lever and tighten the adjustment screw slightly (by turning Clockwise) and re-check the clamp firmness. If the lever is tight and will not close, open the lever and loosen the adjustment screw slightly (by turning Counterclockwise) and re-check the clamp firmness. Repeat this procedure until both clamps are adjusted.
3. The clamps should only require minor adjustment after being initially set, unless you change the tool that you are carrying, or change the position of the tool in the QuickLatch.
4. You have to option to lock the tool and the QuickLatch by inserting a padlock through the lock slot with the lever closed. Both QuickLatches may be locked by using 2 padlocks.
5. If travelling without a tool installed, tighten the adjustment cap screw until the clamp closes on itself with a slight resistance in the lever (do not overtighten). This will keep the mount components secure to prevent unnecessary noise or damage.
6. If you find that the rubber edge trim is coming loose from the jaws of the QuickLatch or the base of the Standoff Box, you can place a small bead of RTV Silicone inside the channel of the rubber trim to help hold it in place.

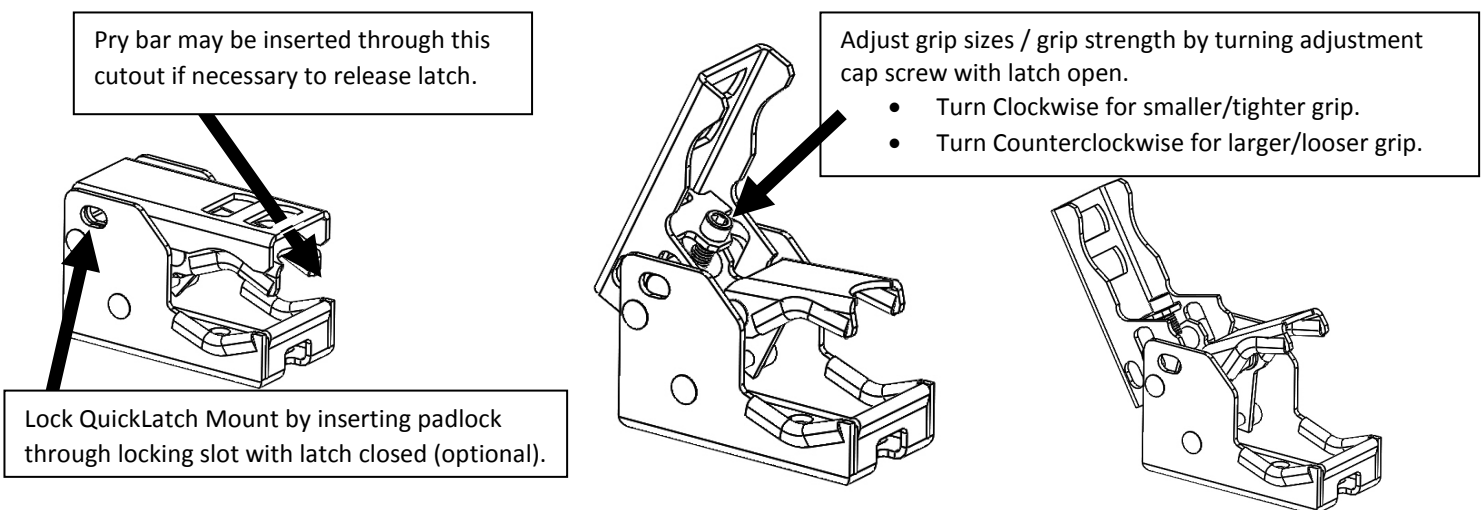

If you need further assistance installing your product, please contact us by email at customerservice@warriorproducts.com or call us at (888) 220-6861.